

Using Screencast-O-Matic in Moodle

(1) In your course, click on “**Create learning activity**”, then under the “**Activities**” tab, choose “**Screencast-O-Matic**”:

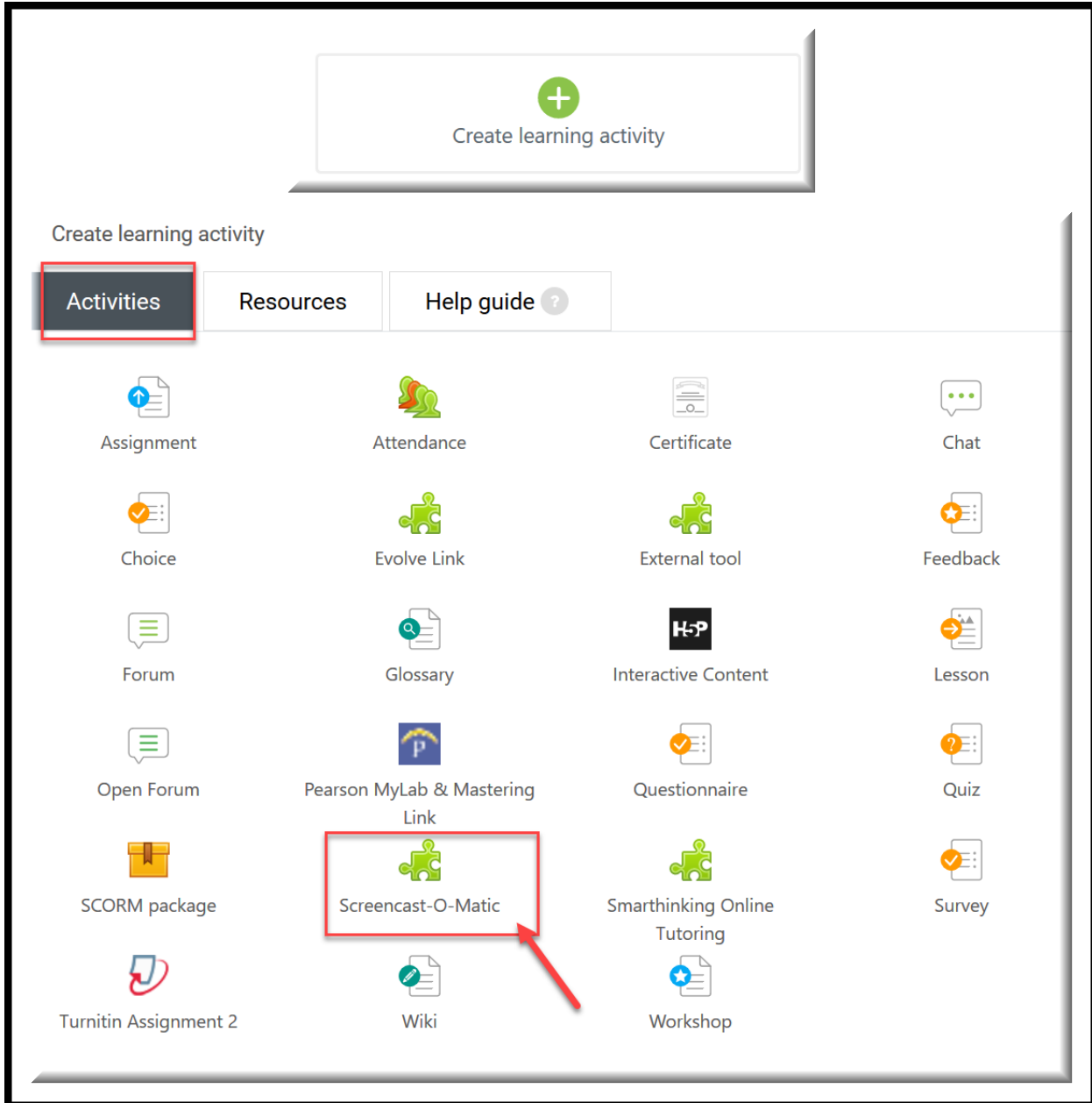

(2)

The screenshot shows a course activity configuration interface. On the left, there is a form with the following fields and options:

- Activity name:** A text input field with a red circle '1' next to it.
- Activity description:** A rich text editor with a toolbar and a red circle '2' next to it.
- Display description on course page:** An unchecked checkbox with a red circle '3' next to it.
- Display activity name when launched:** A checked checkbox with a red circle '4' next to it.
- Display activity description when launched:** An unchecked checkbox with a red circle '4' next to it.
- Preconfigured tool:** A dropdown menu showing 'Screencast-O-Matic' with a red circle '4' next to it.
- Tool URL:** A text input field.
- Secure tool URL:** A text input field.
- Launch container:** A dropdown menu showing 'Default'.
- Consumer key:** A text input field.
- Shared secret:** A text input field with a 'Click to enter text' button.
- Custom parameters:** A text area.
- Icon URL:** A text input field.
- Secure icon URL:** A text input field.
- Show less...:** A button with a red circle '7' next to it.
- Save and return to course:** A button.
- Save and display:** A button.
- Cancel:** A button.

On the right, there is a sidebar with the following settings:

- Visibility:** A dropdown menu showing 'Show on course page'.
- Privacy:** A dropdown menu.
- Grade:** A section with the following settings:
 - Grade:** A dropdown menu showing 'Point' with a red circle '5' next to it.
 - Type:** A dropdown menu showing 'Point'.
 - Scale:** A dropdown menu showing '0 - 200 point scale'.
 - Maximum grade:** A text input field showing '100'.
- Grade category:** A dropdown menu showing 'Not categorized'.
- Grade to pass:** A text input field.
- Common module settings:** A dropdown menu.
- Restrict access:** A dropdown menu.
- Activity completion:** A dropdown menu with a red circle '6' next to it.
- Tags:** A dropdown menu.
- Competencies:** A dropdown menu.
- Expand all:** A button.

1. Enter “**Activity Name**” (for example, “Self-Introduction Video Assignment”)
2. Fill in the “**Activity description**”.
3. Check this box if you want to display description on course page.
4. Check this box if you want to display activity description when launched.
5. Enter your grade settings if you want this activity to be graded.
6. Fill in these settings if needed.
7. Click on “**Save and return to course**”.

(3) Once the activity link is created on the course page, click on it:

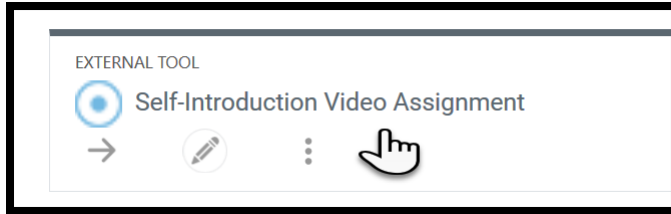

(4) If it's your first time using Screencast-O-Matic, then you'll see a box like this so you can setup an account using your Moodle login:

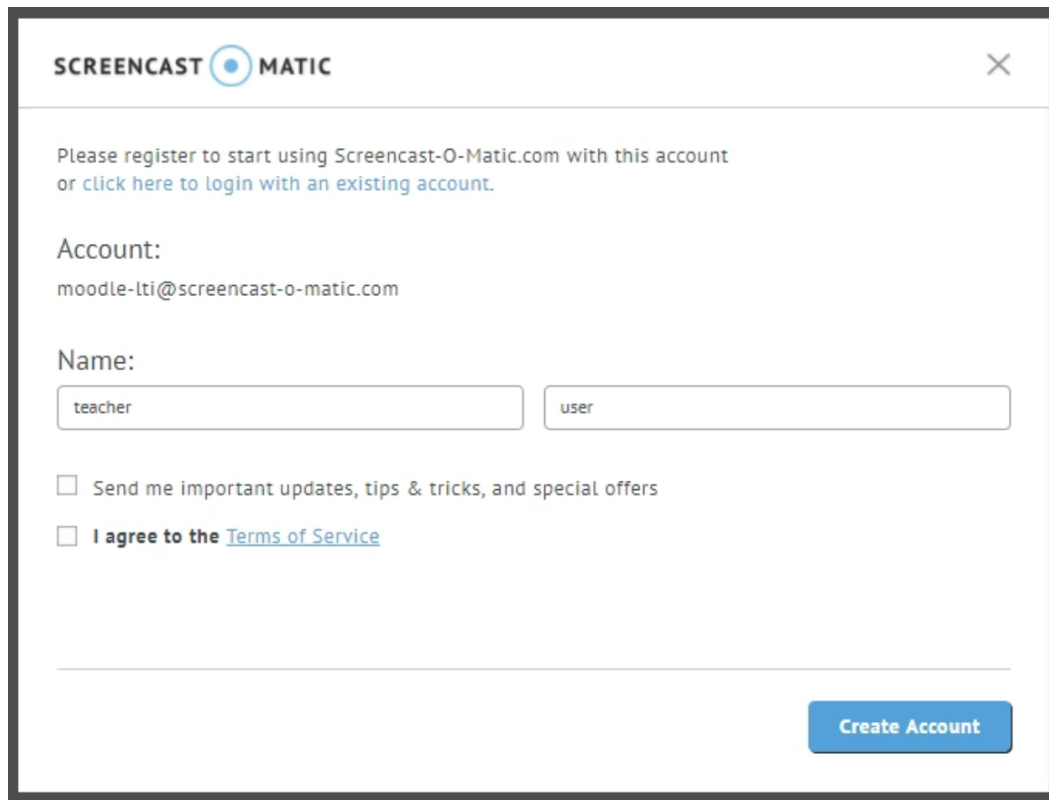
A screenshot of the Screencast-O-Matic registration form. The form is titled "SCREENCAST O-MATIC" and includes a close button (X) in the top right corner. The text reads: "Please register to start using Screencast-O-Matic.com with this account or click here to login with an existing account." Below this, the "Account:" field is pre-filled with "moodle-lti@screencast-o-matic.com". The "Name:" field is split into two input boxes, with "teacher" in the first and "user" in the second. There are two checkboxes: "Send me important updates, tips & tricks, and special offers" and "I agree to the Terms of Service". A blue "Create Account" button is located at the bottom right of the form.

If you already have a Screencast- O-Matic login, then you can also click on the “*Click here to login with an existing account*” link to login with that account or if you've previously logged in at <https://screencast-o-matic.com/HelenaCollegeOnline> then the app will just use that login and skip this step.

(5) Once you're logged in you'll be shown a list of your current uploads at <https://screencast-o-matic.com/HelenaCollegeOnline> so you can easily click to embed a video.

There are three options you can choose depending on your choice of activity:

Note:

There has to be at least one recording uploaded in your channel in order for your channel to be visible here.

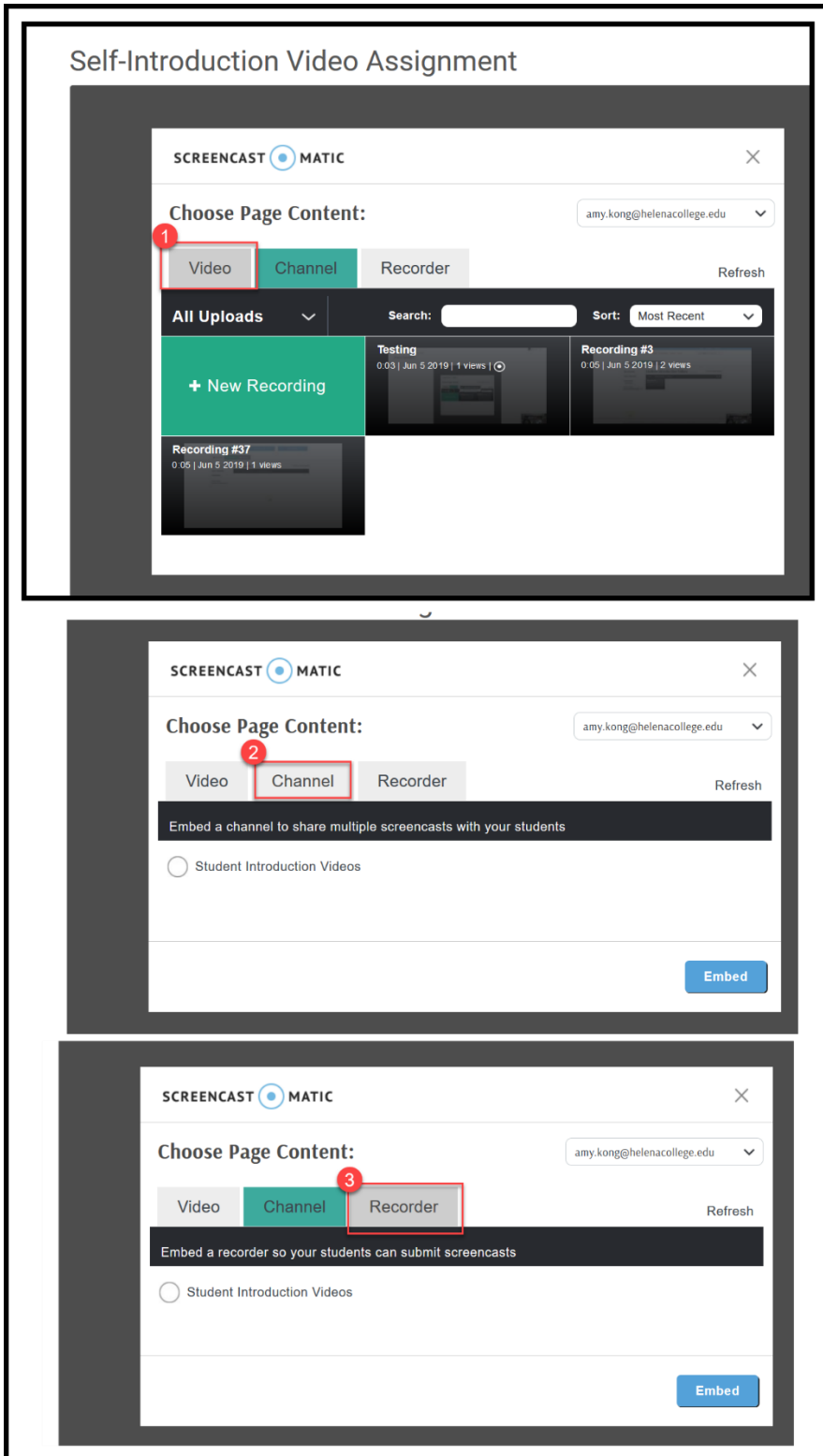

1. You can choose a video to embed in Moodle or click the “New Recording” button to launch the recorder from your browser to create a new recording.

2. You can also embed an entire video channel for student assignments. Under the “**Channel**” tab, select a channel to include. Click embed channel. When your students access to this activity, the video channel will be available for viewing.

3. You can also embed the screen recorder for student assignments. To add the recorder, go to the “Recorder” Tab and select the channel where you want student videos uploaded. Click embed. Students can now access this activity and create their own videos for an assignment. The videos they create will be uploaded automatically to your selected channel.
* Please read the notes about this option on the next page.

For this option, students won't be able to see each other's video submissions (good for mid-term/final exam, etc).

If you do want students to be able to see each other's video submissions (good for group projects or peer review assignments, etc), then please ignore the Option 3 instructions from above and read the following instructions instead:

<https://helenacollege.edu/online/docs/instruction-handout-creating-video-assignments-using-som-in-moodle.pdf>